

# 2008 Antiqua<sup>®</sup>

BY STARCRAFT  
Lightweight Towables



185SB



215DBB XLT

expandables

XLT

ultra-lites



# Antigua expandables



Quality starts with attitude. At Starcraft, we've always referred to that attitude as *Starcraftsmanship!* It's a working philosophy that starts with research and design, and carries all the way through production to sales and service. It's our way of bringing you more in terms of value, service and warranty.

It's a standard of excellence, a frame of mind. *Our* frame of mind. *Our* standard of excellence. A standard of quality and craftsmanship we continually strive to expand every day.

When you take the best ideas, designs, materials and people, and put them all together, year after year, you earn a reputation. That reputation goes on the line every time we sell another product. Add up the reasons for our success, and you have the best reason of all to buy a Starcraft ... *Starcraftsmanship.*



185SB Sand w/Harmony White Décor

Want terrific eye appeal, comfortable function and a surprising number of standard amenities? Starcraft's Antigua is what you've been waiting for! Bright white cabinetry with Thermofoil® raised-panel doors coordinates handsomely with a choice of three contemporary, patterned fabrics: Camelot green, slate blue or sand. Black appliances offer bold contrast and include a 3-burner black cooktop (optional oven shown), a lighted power range hood and a Dometic® double-door refrigerator. The double bowl sink has a brushed nickel faucet, and, as with all Starcrafts, storage abounds throughout.



**LEGEND:**  COMFORT AREAS  VINYL  CARPET  STORAGE

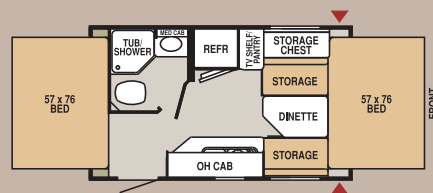

165RB

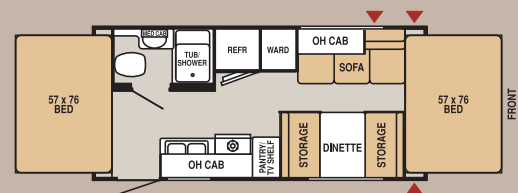

195CK

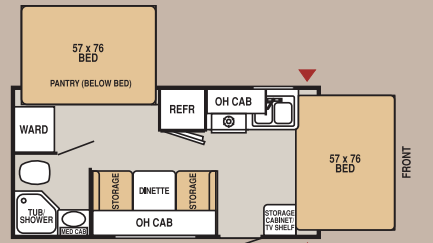

185SB

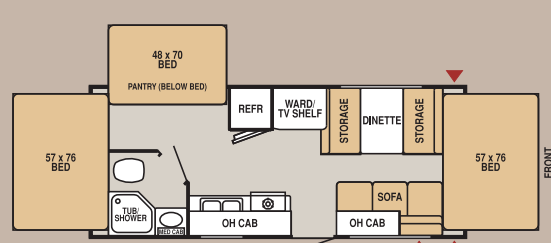

215SB

# Antigua XLT

## ultra-lites



**185SB Sand w/Harmony White Décor**

Look at the tremendous storage beneath and next to this side bunkend! All Antigua expandables have two, and sometimes *three* foldout bunks, all with comfortable 4" cushions. Or choose a combination of bunkends *and* slideouts for exceptionally enhanced living space.



**185SB Sand w/Harmony White Décor**

Antigua dinettes have generous underseat storage, a wood-trimmed table top and new contoured, B-Back foam dinette cushion backs for first-rate seating comfort. Overhead cabinets, mini blinds, wall border and cherry wood grain linoleum complete Antigua's unique look.



**215DBB XLT Camelot Gr w/Harmony White Décor**

Antigua XLT ultra-lite travel trailers are a hard-side alternative to our expandable models. All Antigua XLT models have a queen bedroom as well as two foldout beds. All feature a complete kitchen, bathrooms and plentiful storage.

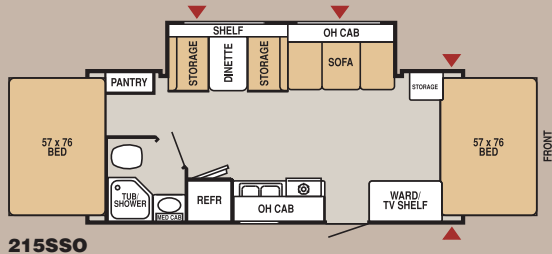

**215SS0**

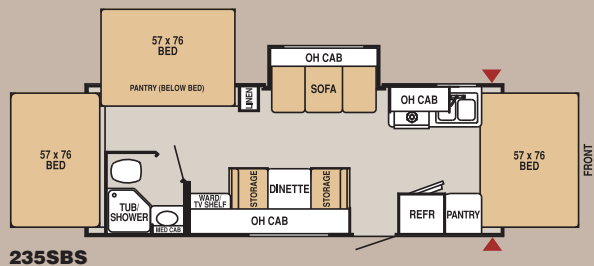

**235SBS**

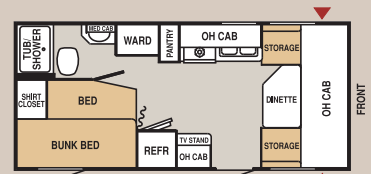

**215DBB**

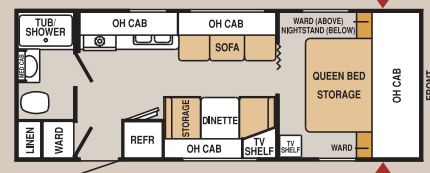

**245QB**

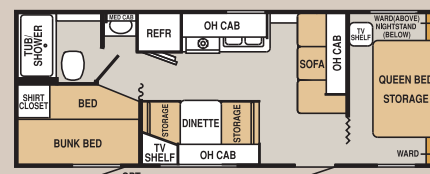

**275RBH**



**215DBB XLT Camelot Green  
w/Harmony White Décor**

This large front U-lounge provides a great gathering space for the whole gang by day, and comfortable sleeping at night. Black appliances, mirrored overhead cabinet inserts and new window treatments with hard valances and mini blinds all contribute to the XLT's functional beauty. Storage cubbies and cabinets are placed wherever possible.



**215DBB  
XLT**

A curved shower rod enhances space in this ABS tub/shower combination with built-in shelves for toiletries. Standard amenities include a skylight, large lavatory sink, freshwater toilet, installed towel ring and toilet tissue holder and a mirrored medicine cabinet.

are a cozy,  
tables. Most  
as well as bunk  
, functional

Antigua XLT ultra-lite travel trailers sleep between five and nine people, depending on the model. All have such amenities as a ducted furnace with electronic ignition, a 45-amp power center with battery charger, double 30# LP tanks with cover and automatic regulator, and a 6-gallon LP water heater with bypass.

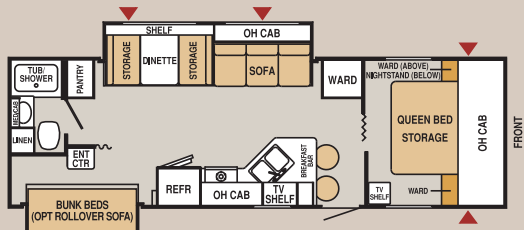

**285SSO**

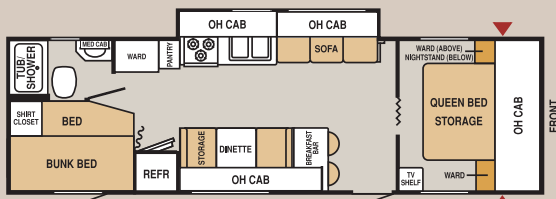

**305QBS**



## Specifications – WEIGHTS, MEASUREMENTS & CAPACITIES

Antigua Expandables	165RB	185SB	195CK	215SB	215SSO	235SBS
GVWR (gross vehicle weight rating – lbs.)	3500	3700	5000	5000	5000	5000
UVW (unloaded vehicle weight – approx. lbs.)	2570	2628	2998	3271	3741	3713
HW (hitch weight – approx. lbs.)	314	467	344	450	541	545
CCC (cargo carrying capacity – approx. lbs.)	570	712	1642	1369	899	927
Overall Length (add 11" for opt. spare tire & carrier) – Center of Ball to Bumper	16' 11"	19' 6"	20' 4"	22' 5"	22' 5"	24' 9"
Overall Length (bunk(s) open)	21' 10"	20' 2"	25' 2"	27' 3"	27' 3"	29' 7"
Body Width	7' 7"	7' 7"	7' 7"	7' 7"	7' 7"	7' 7"
Interior Height	6' 4"	6' 4"	6' 4"	6' 4"	6' 4"	6' 4"
Overall Exterior Height (add 8" for opt. A/C)	9' 0"	9' 0"	9' 0"	9' 0"	9' 0"	9' 0"
Tire Size	ST205/75D 14C	ST205/75D 14C	ST205/75D 14C	ST205/75D 14C	ST205/75D 14C	ST205/75D 14C
Ducted Furnace w/Electronic Ignition	19M BTU	19M BTU	19M BTU	19M BTU	19M BTU	19M BTU
6-Gallon LP Water Heater w/Bypass	X	X	X	X	X	X
Freshwater System w/12-Volt Quiet Pump – Includes Water Heater (approx.)	36 gal. under floor	36 gal. under floor	36 gal. under floor	36 gal. under floor	36 gal. under floor	36 gal. under floor
Gray/Black Holding Tanks (approx.)	27/25 gal.	27/25 gal.	27/25 gal.	27/25 gal.	27/25 gal.	27-27/25 gal.
Double 30# LP Tanks w/Auto Regulator	X	X	X	X	X	X
45-AMP Power Center w/Battery Charger	X	X	X	X	X	X
Straight Axle(s) w/All-Wheel Electric Brakes	1	1	2	2	2	2
Ball Coupler	2 5/16"	2 5/16"	2 5/16"	2 5/16"	2 5/16"	2 5/16"
Sleeping Capacity	6	6	8	10	8	10
Antigua XLT Ultra-Lites	215DBB	245QB	275RBH	285SSO	305QBS	
GVWR (gross vehicle weight rating – lbs.)	5800	5800	7100	7100	7100	
UVW (unloaded vehicle weight – approx. lbs.)	3317	3957	4463	5161	4708	
HW (hitch weight – approx. lbs.)	377	349	532	548	603	
CCC (cargo carrying capacity – approx. lbs.)	2123	1483	2277	1464	1917	
Overall Length (add 11" for opt. spare tire & carrier) – Center of Ball to Bumper	22' 8"	26' 0"	29' 1"	31' 0"	31' 11"	
Body Width	8' 0"	8' 0"	8' 0"	8' 0"	8' 0"	
Interior Height	6' 6"	6' 6"	6' 6"	6' 6"	6' 6"	
Overall Exterior Height (add 8" for opt. A/C)	9' 3"	9' 3"	9' 3"	9' 6"	9' 6"	
Tire Size	ST205/75D 14C	ST205/75D 14C	ST205/75D 14C	ST205/75D 14C	ST205/75D 14C	
Ducted Furnace w/Electronic Ignition	19M BTU	19M BTU	19M BTU	19M BTU	19M BTU	
6-Gallon LP Water Heater w/Bypass	X	X	X	X	X	
Freshwater System w/12-Volt Quiet Pump – Includes Water Heater (approx.)	36 gal. under floor	36 gal. under floor	36 gal. under floor	36 gal. under floor	36 gal. under floor	
Gray/Black Holding Tanks (approx.)	26/26 gal.	26/30 gal.	26/26 gal.	30-35/30 gal.	26/26 gal.	
Double 30# LP Tanks w/Auto Regulator & Cover	X	X	X	X	X	
45-AMP Power Center w/Battery Charger	X	X	X	X	X	
Straight Axle(s) w/All-Wheel Electric Brakes	2	2	2	2	2	
Ball Coupler	2 5/16"	2 5/16"	2 5/16"	2 5/16"	2 5/16"	
Sleeping Capacity	5	6	9	8	9	

**GVWR – Gross Vehicle Weight Rating**  
The maximum permissible weight of the trailer when fully loaded with all systems filled. It includes all weight at the trailer axle(s) plus hitch.

**UVW – Unloaded Vehicle Weight**  
Sometimes referred to as the Gross Vehicle Weight or Curb Weight, the UVW is the dry weight of the trailer as manufactured at the factory. It includes all weight at the trailer axle(s) plus hitch.

**HW – Hitch Weight**  
Hitch Weight represents the portion of the trailer weight that is carried by the tongue to the hitch ball on the tow vehicle.

**CCC – Cargo Carrying Capacity**  
Sometimes referred to as Rated Cargo Load, the CCC is equal to the GVWR minus each of the following: UVW, full fresh water weight (including water heater) plus filled propane tank(s) and battery weight.

### ANTIGUA EXPANDABLE OPTIONS

Camelot Green w/Harmony White Décor	13.5M-BTU Duo-Therm™ Air Conditioner
Slate Blue w/Harmony White Décor	Aluminum Wheels
Sand w/Harmony White Décor	Oven
Convenience Package: Privacy Drape(s), LP Tank Cover, Monitor Panel, Sink Cover, Sand Pads	Carryout Gas Grill Bunk Fan Light Second Bunk Fan Light
Program Package: A&E Systems Awning, TV Antenna, Spare Tire w/Cover & Carrier, AM/FM/CD Stereo w/Outside Speakers, Skylight over Shower in Bath	Third Bunk Fan Light (215SB, 235SBS) Raised Refrigerator Panels Clip-On Bumper Cover Tinted Safety Glass Windows
Comfort Package: Dometic® Microwave, Outside Shower, Gas/Electric DSI Water Heater	15" LCD TV & DVD Player Slideout Topper(s) (215SSO, 235SBS)

### ANTIGUA XLT ULTRA-LITE OPTIONS

Camelot Green w/Harmony White Décor	Pack-N-Play Door (215DBB, 275RBH, 305QBS)
Slate Blue w/Harmony White Décor	
Sand w/Harmony White Décor	Raised Refrigerator Panels
Program Package: A&E Systems Awning, TV Antenna, Spare Tire w/Cover & Carrier, AM/FM/CD Stereo w/Outside Speakers	Rollover Sofa in Bunk Slideout (285SSO) Aluminum Wheels Tinted Safety Glass Windows
Ducted 13.5M-BTU Duo-Therm™ Air Conditioner (215DBB non-ducted)	Clip-On Bumper Cover Exterior Storage Drawer
Carryout Gas Grill	15" LCD TV & DVD Player
Slideout Topper – Bunk Beds (285SSO)	Outside Shower
Dometic® Microwave	Slideout Topper (305QBS)
Gas/Electric DSI Water Heater	Slideout Topper – Dinette/Sofa (285SSO)
Front Window w/Rock Guard (215DBB)	

# STARCRAFT®

## 2008 Antigua Lightweight Towables



All Antiguas offer a large pass-through compartment that holds tons of gear.



An optional Pack-N-Play door, offered in most XLTs, allows easy interior access, so you can stow bikes and other gear safely inside.



The 185SB expandable offers this great storage cabinet with TV counter and cable hook-up.

## décor

### Décor Key:

- A** – Dinette & Sofa & Hard Valance
- B** – Bedspread & Bunk Valance
- C** – Window & Privacy Drape
- D** – Bunk Mat
- E** – Bunk Valance
- F** – Bedspread; Window & Privacy Drape

## Warranty

### Info.\*

- 1-Year Hitch-to-Bumper
- 7-Year Aqualon®-7 Tent (expandables)
- 12-Year Roof Covering
- 2- and/or 3-Year Appliances

\*Refer to Actual Warranty Information for Details.



Join  
the Starcraft  
Camper Club...

When you purchase a new Antigua Lightweight Towable, you'll receive a free one-year membership to the Starcraft Camper Club, a camping group of Starcraft owners. Our club offers you the friendship and security of caravan-style travel at lower group rates. Organized trips and gatherings are held throughout the year and detailed in the club's quarterly publication, *Chatter*. Participating in the Starcraft Camper Club is a great way to develop friendships with people who have the same interests and share your love of RVing.

Go RVing®

# STARCRAFT®

Be sure to visit our website at [www.starcraftrv.com](http://www.starcraftrv.com) for the latest product updates and floorplans, additional in-depth specs and information, and to locate your nearest dealer.

©2007 Starcraft RV, Inc. • P.O. Box 458 • Topeka, IN 46571 • (260) 593-2550  
Due to constant product improvements, Starcraft RV, Inc. reserves the right to make changes, including (but not limited to) equipment, accessories, colors and prices without further notice or obligation. Some equipment shown separately, or on product illustrated in this catalog, may be optional at extra cost.